



## 2015 **Spectrum Series** Product Brochure

The Spectrum Series is the best option for a budget Electric/Motorized front projection screen.



# Spectrum Series

The Spectrum Series is the best option for a budget Electric/Motorized front projection screen.

Scan for product



video



## Screen Material:

- MaxWhite 1.1 Gain Screen Material is durable and easy to clean
- 180° wide viewing angle for commercial and residential presentations
- Black backed\* screen material eliminates light penetration for superior color reproduction
- Black masking enhances picture contrast
- Available in AcousticPro UHD Sound Transparent Material, 1.0 Gain, Moiré-free

## Casing and Installation:

- Durable metal casing
- Suitable for wall/ceiling installations
- Ships fully assembled with 3-prong power connection ready to Plug & Play
- Optional 6" or 12" brackets available

## Motor System:

- Synchronized Motor is silent, energy efficient and enhances product longevity

## Control System:

- Infrared remote and wall switch
- Internal IR/RF low voltage receivers
- 3 way wall switch
- 5-12 volt trigger synchronizes with projector
- Optional RF, In-Wall up/down switch and 5-12V controls available

## Quality and Reliability:

- Standard 2-year parts and labor warranty
- 3-year warranty for ENR-G (Educational, Non-profit, Religious or Government/Military) - US only
- ETL, FCC, CE, CB GOSTCE & ISO9001:2008 Certified

## Certified

- GREENGUARD® and GREENGUARD® Gold UL 2818 Certified



The Spectrum Series has 4, 6 or 8 inches of top masking to complement the side and bottom borders. This provides a professional effect by properly framing your projected image.  
(Please refer to the dimensions table for exact dimensions for each model)

\*on MaxWhite material only

Standard Internal Infrared (IR) and Radio Frequency (RF) Receivers for optional RF remote provide total control while maintaining the streamlined simplicity of this product.

For added durability and enhanced product appearance, the Elite Spectrum Series uses an all-steel casing construction including the end caps.

The Spectrum Series has various control options that work in conjunction with its Low Voltage Controller (LVC). Its 5-12 Volt trigger port uses a standard RJ45 connection and synchronizes the screen's drop and rise with your projector's power cycle. The optional wall box kit can be installed as an external wall-mounted control or use the extended IR "EYE" receiver for recessed ceiling installations.

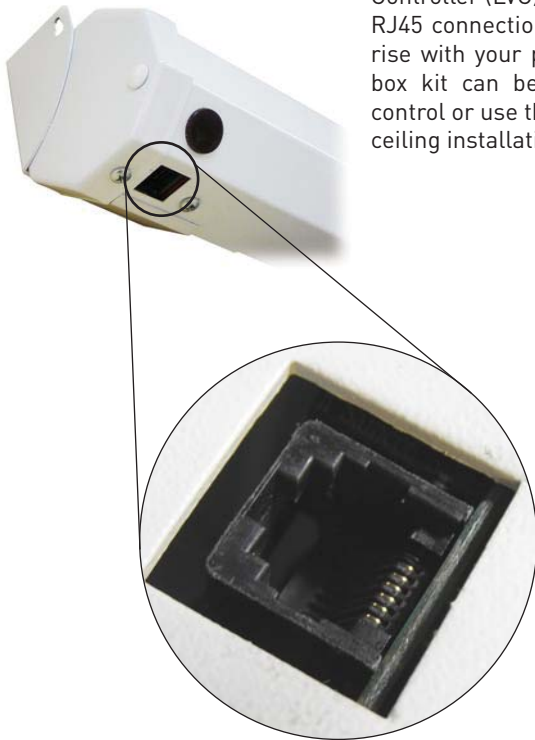

Elite Screens MaxWhite screen material is the most popular screen material for today's projectors. It is easy to clean and durable for daily use. With the 1.1 gain and 180° wide viewing angle, it is suitable for most applications from commercial to home theater presentations.

Screen material comes with standard black backing (MaxWhite only) to eliminate light penetration while its textured projection surface helps to eliminate Moiré or "hot spotting".

## Spectrum Series

| Model                | Screen Diag. & Aspect Ratio | View Height (in) | View Width (in) | View Height (cm) | View Width (cm) | N.W. (lbs.) | G.W. (lbs.) | N.W. (kgs) | G.W. (Kgs) | Packaging Dimensions (LxHxW) | Gain | Screen Material   | Case Color |
|----------------------|-----------------------------|------------------|-----------------|------------------|-----------------|-------------|-------------|------------|------------|------------------------------|------|-------------------|------------|
| Electric84V          | 84"(4:3)                    | 50.4             | 67.2            | 128.0            | 170.7           | 19.3        | 22.6        | 8.8        | 10.3       | 82"x5.5"x5"                  | 1.1  | MaxWhite          | White      |
| Electric100V         | 100"(4:3)                   | 60.0             | 80.0            | 152.4            | 203.2           | 21.6        | 26.8        | 9.8        | 12.2       | 97.99"x5.5"x5.5"             | 1.1  | MaxWhite          | White      |
| Electric120V         | 120"(4:3)                   | 72.0             | 96.0            | 182.9            | 243.8           | 25.5        | 30.5        | 11.6       | 13.9       | 112"x5.5"x5.5"               | 1.1  | MaxWhite          | White      |
| Electric84H          | 84"(16:9)                   | 41.2             | 73.2            | 104.6            | 185.9           | 18.5        | 22.6        | 8.4        | 10.3       | 87.8"x5.5"x5.5"              | 1.1  | MaxWhite          | Black      |
| Electric100H         | 100"(16:9)                  | 49.0             | 87.2            | 124.5            | 221.5           | 20.1        | 26.8        | 9.1        | 12.2       | 104.92"x5.5"x5.5"            | 1.1  | MaxWhite          | Black      |
| Electric110H         | 110"(16:9)                  | 54.0             | 96.0            | 137.2            | 243.8           | 23.6        | 30.0        | 10.7       | 13.6       | 113.94"x5.5"x5.5"            | 1.1  | MaxWhite          | Black      |
| Electric125H         | 125"(16:9)                  | 61.3             | 109.0           | 155.7            | 276.9           | 30.9        | 36.4        | 14.0       | 16.6       | 124.8"x5.5"x5.5"             | 1.1  | MaxWhite          | Black      |
| Electric150H         | 150"(16:9)                  | 73.6             | 130.7           | 186.9            | 332.0           | 35.3        | 41.9        | 16.1       | 19.1       | 146.5"x5.5"x5.9"             | 1.1  | MaxWhite          | Black      |
| Electric180H         | 180"(16:9)                  | 88.3             | 156.9           | 224.3            | 398.5           | 52.9        | 68.3        | 24.1       | 31.1       | 171"x6.7"x6.7"               | 1.1  | MaxWhite          | Black      |
| Electric85X          | 85"(16:10)                  | 45.0             | 72.0            | 114.3            | 182.9           | 18.3        | 21.9        | 8.3        | 10.0       | 87.4"x5.5"x5.7"              | 1.1  | MaxWhite          | White      |
| Electric90X          | 90"(16:10)                  | 47.5             | 76.0            | 120.7            | 193.0           | 19.0        | 22.4        | 8.6        | 10.2       | 91"x5.5"x5.7"                | 1.1  | MaxWhite          | White      |
| Electric106X         | 106"(16:10)                 | 56.2             | 90.0            | 142.7            | 228.6           | 21.0        | 25.9        | 9.6        | 11.8       | 106.1"x5.5"x5.5"             | 1.1  | MaxWhite          | Black      |
| Electric128X         | 128"(16:10)                 | 67.8             | 108.4           | 172.2            | 275.3           | 25.5        | 31.9        | 11.6       | 14.5       | 123.6"x5.5"x5.5"             | 1.1  | MaxWhite          | Black      |
| Electric142X         | 142"(16:10)                 | 75.3             | 120.4           | 191.2            | 305.9           | 39.9        | 47.4        | 18.1       | 21.5       | 135"x6.10"x6.3"              | 1.1  | MaxWhite          | Black      |
| Electric100H-A1080P2 | 100"(16:9)                  | 49.0             | 87.2            | 124.5            | 221.5           | 20.1        | 26.8        | 9.1        | 12.2       | 104.92"x5.5"x5.5"            | 1.0  | AcousticPro1080P2 | Black      |
| Electric125H-A1080P2 | 125"(16:9)                  | 61.3             | 109.0           | 155.7            | 276.9           | 30.9        | 36.4        | 14.0       | 16.6       | 124.8"x5.5"x5.5"             | 1.0  | AcousticPro1080P2 | Black      |
| Electric100H-AUHD    | 100"(16:9)                  | 49.0             | 87.2            | 124.5            | 221.5           | 21.3        | 25.5        | 9.7        | 11.6       | 104.92"x5.2"x5.35"           | 1.0  | AcousticPro UHD   | Black      |
| Electric125H-AUHD    | 125"(16:9)                  | 61.3             | 109.0           | 155.7            | 276.9           |             |             |            |            |                              | 1.0  | AcousticPro UHD   | Black      |

Please visit [www.elitescreens.com](http://www.elitescreens.com)

Spectrum Series Dimensions Table

| Model                | Screen Diag. & Aspect Ratio | Case Length (A) | View Width (A1) | Screen Width (A2) | Screw Hole Distance (A3) | Weight Bar Length (A4) | Overall Height (B) | View Height (B1) | B2   | B3 | End cap Height (B4) | Top Black Border (B5) | C1 | End cap Width (C2) | Power Cord Length (D) |
|----------------------|-----------------------------|-----------------|-----------------|-------------------|--------------------------|------------------------|--------------------|------------------|------|----|---------------------|-----------------------|----|--------------------|-----------------------|
| Electric84H          | 84"(16:9)                   | 2168            | 1860            | 1936              | 2113                     | 2016                   | 1402               | 1046             | 1309 | 60 | 93                  | 203                   | 17 | 80                 | 1800                  |
| Electric100H         | 100"(16:9)                  | 2544            | 2214            | 2314              | 2489                     | 2394                   | 1551               | 1245             | 1458 | 60 | 93                  | 152                   | 17 | 80                 | 1800                  |
| Electric100H-A1080P2 | 100"(16:9)                  | 2544            | 2214            | 2314              | 2489                     | 2394                   | 1551               | 1245             | 1458 | 60 | 93                  | 152                   | 17 | 80                 | 1800                  |
| Electric100H-AUHD    | 100"(16:9)                  | 2544            | 2214            | 2314              | 2489                     | 2394                   | 1551               | 1245             | 1458 | 60 | 93                  | 152                   | 17 | 80                 | 1800                  |
| Electric110H         | 110"(16:9)                  | 2773            | 2435            | 2535              | 2718                     | 2615                   | 1726               | 1370             | 1633 | 60 | 93                  | 203                   | 17 | 80                 | 1800                  |
| Electric125H         | 125"(16:9)                  | 3103            | 2769            | 2869              | 3048                     | 2956                   | 1846               | 1557             | 1753 | 60 | 93                  | 203                   | 17 | 80                 | 1800                  |
| Electric125H-A1080P2 | 125"(16:9)                  | 3103            | 2769            | 2869              | 3048                     | 2956                   | 1846               | 1557             | 1753 | 60 | 93                  | 203                   | 17 | 80                 | 1800                  |
| Electric125H-AUHD    | 125"(16:9)                  | 3103            | 2769            | 2869              | 3048                     | 2956                   | 1846               | 1557             | 1753 | 60 | 93                  | 203                   | 17 | 80                 | 1800                  |
| Electric150H         | 150"(16:9)                  | 3622            | 3321            | 3421              | 3567                     | 3501                   | 2135               | 1868             | 2030 | 60 | 105                 | 102                   | 17 | 88                 | 2500                  |
| Electric180H         | 180"(16:9)                  | 4276            | 3985            | 4085              | 4221                     | 4165                   | 2559               | 2242             | 2454 | 60 | 105                 | 152                   | 17 | 88                 | 2500                  |
| Electric84V          | 84"(4:3)                    | 2016            | 1707            | 1783              | 1961                     | 1863                   | 1636               | 1280             | 1543 | 60 | 93                  | 203                   | 17 | 80                 | 1800                  |
| Electric100V         | 100"(4:3)                   | 2366            | 2032            | 2132              | 2311                     | 2212                   | 1804               | 1524             | 1711 | 60 | 93                  | 127                   | 17 | 80                 | 1800                  |
| Electric120V         | 120"(4:3)                   | 2773            | 2438            | 2538              | 2718                     | 2618                   | 2083               | 1829             | 1990 | 60 | 93                  | 102                   | 17 | 80                 | 1800                  |
| Electric85X          | 85"(16:10)                  | 2140            | 1831            | 1907              | 2085                     | 1987                   | 1399               | 1144             | 1306 | 60 | 93                  | 102                   | 17 | 80                 | 1800                  |
| Electric90X          | 90"(16:10)                  | 2248            | 1939            | 2015              | 2193                     | 2095                   | 1466               | 1212             | 1373 | 60 | 93                  | 102                   | 17 | 80                 | 1800                  |
| Electric106X         | 106"(16:10)                 | 2618            | 2283            | 2383              | 2563                     | 2463                   | 1682               | 1427             | 1589 | 60 | 93                  | 102                   | 17 | 80                 | 1800                  |
| Electric128X         | 128"(16:10)                 | 3091            | 2756            | 2832              | 3036                     | 2937                   | 1978               | 1723             | 1885 | 60 | 93                  | 102                   | 17 | 80                 | 1800                  |
| Electric142X         | 142"(16:10)                 | 3360            | 3059            | 3159              | 3305                     | 3239                   | 2686               | 1912             | 2581 | 60 | 105                 | 102                   | 17 | 80                 | 2500                  |

Unit: mm

| Model                | Screen Diag. & Aspect Ratio | Case Length (A) | View Width (A1) | Screen Width (A2) | Screw Hole Distance (A3) | Weight Bar Length (A4) | Overall Height (B) | View Height (B1) | B2    | B3  | End cap Height (B4) | Top Black Border (B5) | C1  | End cap Width (C2) | Power Cord Length (D) |
|----------------------|-----------------------------|-----------------|-----------------|-------------------|--------------------------|------------------------|--------------------|------------------|-------|-----|---------------------|-----------------------|-----|--------------------|-----------------------|
| Electric84H          | 84"(16:9)                   | 85.4            | 73.2            | 76.2              | 83.2                     | 79.4                   | 55.2               | 41.2             | 51.5  | 2.4 | 3.7                 | 8.0                   | 0.7 | 3.1                | 70.9                  |
| Electric100H         | 100"(16:9)                  | 100.2           | 87.2            | 91.1              | 98.0                     | 94.3                   | 61.1               | 49.0             | 57.4  | 2.4 | 3.7                 | 6.0                   | 0.7 | 3.1                | 70.9                  |
| Electric100H-A1080P2 | 100"(16:9)                  | 100.2           | 87.2            | 91.1              | 98.0                     | 94.3                   | 61.1               | 49.0             | 57.4  | 2.4 | 3.7                 | 6.0                   | 0.7 | 3.1                | 70.9                  |
| Electric100H-AUHD    | 100"(16:9)                  | 100.2           | 87.2            | 91.1              | 98.0                     | 94.3                   | 61.1               | 49.0             | 57.4  | 2.4 | 3.7                 | 6.0                   | 0.7 | 3.1                | 70.9                  |
| Electric110H         | 110"(16:9)                  | 109.2           | 95.9            | 99.8              | 107.0                    | 103.0                  | 68.0               | 53.9             | 64.3  | 2.4 | 3.7                 | 8.0                   | 0.7 | 3.1                | 70.9                  |
| Electric125H         | 125"(16:9)                  | 122.2           | 109.0           | 113.0             | 120.0                    | 116.4                  | 72.7               | 61.3             | 69.0  | 2.4 | 3.7                 | 8.0                   | 0.7 | 3.1                | 70.9                  |
| Electric125H-A1080P2 | 125"(16:9)                  | 122.2           | 109.0           | 113.0             | 120.0                    | 116.4                  | 72.7               | 61.3             | 69.0  | 2.4 | 3.7                 | 8.0                   | 0.7 | 3.1                | 70.9                  |
| Electric125H-AUHD    | 125"(16:9)                  | 122.2           | 109.0           | 113.0             | 120.0                    | 116.4                  | 72.7               | 61.3             | 69.0  | 2.4 | 3.7                 | 8.0                   | 0.7 | 3.1                | 70.9                  |
| Electric150H         | 150"(16:9)                  | 142.6           | 130.7           | 134.7             | 140.4                    | 137.8                  | 84.1               | 73.5             | 79.9  | 2.4 | 4.1                 | 4.0                   | 0.7 | 3.5                | 98.4                  |
| Electric180H         | 180"(16:9)                  | 168.3           | 156.9           | 160.8             | 166.2                    | 164.0                  | 100.7              | 88.3             | 96.6  | 2.4 | 4.1                 | 6.0                   | 0.7 | 3.5                | 98.4                  |
| Electric84V          | 84"(4:3)                    | 79.4            | 67.2            | 70.2              | 77.2                     | 73.3                   | 64.4               | 50.4             | 60.7  | 2.4 | 3.7                 | 8.0                   | 0.7 | 3.1                | 70.9                  |
| Electric100V         | 100"(4:3)                   | 93.1            | 80.0            | 83.9              | 91.0                     | 87.1                   | 71.0               | 60.0             | 67.4  | 2.4 | 3.7                 | 5.0                   | 0.7 | 3.1                | 70.9                  |
| Electric120V         | 120"(4:3)                   | 109.2           | 96.0            | 99.9              | 107.0                    | 103.1                  | 82.0               | 72.0             | 78.3  | 2.4 | 3.7                 | 4.0                   | 0.7 | 3.1                | 70.9                  |
| Electric85X          | 85"(16:10)                  | 84.3            | 72.1            | 75.1              | 82.1                     | 78.2                   | 55.1               | 45.0             | 51.4  | 2.4 | 3.7                 | 4.0                   | 0.7 | 3.1                | 70.9                  |
| Electric90X          | 90"(16:10)                  | 88.5            | 76.3            | 79.3              | 86.3                     | 82.5                   | 57.7               | 47.7             | 54.1  | 2.4 | 3.7                 | 4.0                   | 0.7 | 3.1                | 70.9                  |
| Electric106X         | 106"(16:10)                 | 103.1           | 89.9            | 93.8              | 100.9                    | 97.0                   | 66.2               | 56.2             | 62.6  | 2.4 | 3.7                 | 4.0                   | 0.7 | 3.1                | 70.9                  |
| Electric128X         | 128"(16:10)                 | 121.7           | 108.5           | 111.5             | 119.5                    | 115.6                  | 77.9               | 67.8             | 74.2  | 2.4 | 3.7                 | 4.0                   | 0.7 | 3.1                | 70.9                  |
| Electric142X         | 142"(16:10)                 | 132.3           | 120.4           | 124.4             | 130.1                    | 127.5                  | 105.7              | 75.3             | 101.6 | 2.4 | 4.1                 | 4.0                   | 0.7 | 3.1                | 98.4                  |

Unit: inch

**Note: Data Error  $\pm 1"$ .** The listed measurements are for general reference only. Please contact Elite Screens to verify product design and dimensions before attempting to integrate its products with any structural or furniture modification. Although a manufacturer may offer product advice, it may be taken or disregarded at the integrator's discretion. Elite Screens will not be held responsible or be otherwise liable for faulty installations.

