

vtech[®]

Instruction Manual

Twist & Teach Animal Cube



VTech understands that a child's needs and abilities change as they grow and with that in mind we develop our toys to teach and entertain at just the right level...

vtech *Baby*

Toys that will stimulate their interest in different textures, sounds and colours

I am...

...responding to colours, sounds and textures

...understanding cause and effect

...learning to touch, reach, grasp, sit-up, crawl and toddle

Birth-36 months



Pre-School

Interactive toys to develop their imagination and encourage language development

I want...

...to get ready for school by starting to learn the alphabet and counting

...my learning to be as fun, easy and exciting as can be

...to show my creativity with drawing and music so my whole brain develops

3-6 years



Electronic Learning Computers

Cool, aspirational and inspiring computers for curriculum related learning

I need...

...challenging activities that can keep pace with my growing mind

...intelligent technology that adapts to my level of learning

...National Curriculum based content to support what I'm learning at school

4-10 years



To learn more about this and other VTech® products, visit www.vtech.co.uk

INTRODUCTION

Play and learn with us! Twist and discover with the **Twist & Teach Animal Cube** by **VTech®**. Cute, twisting cube made especially for babies. Turn the cube left or right to trigger fun learning phrases while being introduced to animals, phonics, vehicles and colours. 4 light up buttons on top of the cube encourage baby to interact, twist & discover. Cube can recognise different animal and vehicle combinations every time baby twists!

Light Up Buttons



On/Off Switch



INCLUDED IN THE PACKAGE

- Twist & Teach Animal Cube
- Quick Start Guide

WARNING

All packing materials such as tape, plastic sheets, packaging locks, removable tags, cable ties, cords and packaging screws are not part of this toy, and should be discarded for your child's safety.

NOTE

Please keep this Instruction Manual as it contains important information.

Unlock the Packaging Locks:

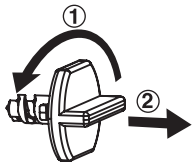

- ① Turn the packaging lock anticlockwise several times.
- ② Pull out and discard the packaging lock.

GETTING STARTED

BATTERY REMOVAL AND INSTALLATION

1. Make sure the unit is turned **OFF**
2. Locate the battery cover on the back of the unit. Use a screwdriver to loosen the screw and then open the battery cover.
3. If used batteries are present, remove these batteries from the unit by pulling up on one end of each battery.
4. Install 2 new AAA batteries following the diagram inside the battery box. (For best performance, alkaline batteries or fully charged Ni-MH rechargeable batteries are recommended).
5. Replace the battery cover and tighten the screw to secure.

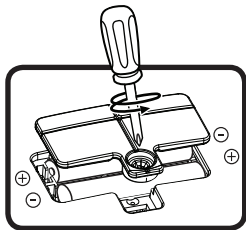

WARNING:

Adult assembly required for battery installation.
Keep batteries out of reach of children.

IMPORTANT: BATTERY INFORMATION

- Insert batteries with the correct polarity (+ and -).
- Do not mix old and new batteries.
- Do not mix alkaline, standard (carbon-zinc) or rechargeable batteries.
- Only batteries of the same or equivalent type as recommended are to be used.
- Do not short-circuit the supply terminals.
- Remove batteries during long periods of non-use.
- Remove exhausted batteries from the toy.
- Dispose of batteries safely. Do not dispose of batteries in fire.

RECHARGEABLE BATTERIES

- Remove rechargeable batteries (if removable) from toy before charging.
- Rechargeable batteries are only to be charged under adult supervision.
- Do not charge non-rechargeable batteries.

Disposal of batteries and product



The crossed-out wheellie bin symbols on products and batteries, or on their respective packaging, indicates they must not be disposed of in domestic waste as they contain substances that can be damaging to the environment and human health.

The chemical symbols Hg, Cd or Pb, where marked, indicate that the battery contains more than the specified value of mercury (Hg), cadmium (Cd) or lead (Pb) set out in the Batteries and Accumulators Regulation.



The solid bar indicates that the product was placed on the market after 13th August, 2005.

Help protect the environment by disposing of your product or batteries responsibly.

VTech® cares for the planet.

Care for the environment and give your toy a second life by disposing of it at a small electricals collection point so all its materials can be recycled.

In the UK:



Visit www.recyclenow.com to see a list of collection points near you.

In Australia & New Zealand:

Check with your local council for kerbside collections.

PRODUCT FEATURES

1. On/Off Switch

To turn the unit **On**, slide the **On/Off Switch** to the **On**  position. You will hear a song, a playful phrase and sounds. To turn the unit **Off**, slide the **On/Off Switch** to the **Off**  position.

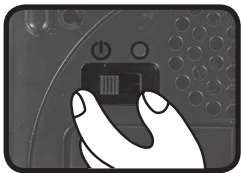

2. Automatic Shut-Off

To preserve battery life, the **Twist & Teach Animal Cube** will automatically shut off after approximately 35 seconds without input. The unit can be turned on again by pressing any button or twisting the cube.

NOTE

If the unit powers down or if the light fades out during play, please install a new set of batteries.

ACTIVITIES

1. Light Up Buttons

Press the four **Light Up Buttons** to learn animal names, letters and colours. Fun animal songs, sounds and melodies will play. The buttons will flash with the sounds.



2. Twisting Cube

Twist the **Cube** to move each animal into four different vehicles to hear fun sounds, phrases and music. The lights will flash with the sounds.

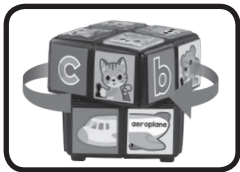

MELODIES

1. Alphabet Song
2. Do You Know the Muffin Man?
3. For He's a Jolly Good Fellow
4. Glow Worm
5. Diddle, Diddle Dumpling
6. Here We Go 'Round the Mulberry Bush
7. Hickory, Dickory, Dock
8. Looby Loo
9. Mary Had a Little Lamb
10. Oh Where, Oh Where Has My Little Dog Gone
11. One, Two, Buckle My Shoe
12. Pease Porridge Hot
13. Oh! Dear, What Can the Matter Be?
14. Rockin' Robin
15. Ten in the Bed
16. Wheels on the Bus

SONG LYRICS

Song 1

1, 2, 3, 4, 5 animal friends are side by side.
Twist and turn with your hands, the cube is so much fun.

Song 2

A green alligator is big and strong.
It loves swamps, marshes and lakes.

Song 3

The bear went over the mountain.
To eat nuts, berries and leaves.

Song 4

Purr, purr goes a cat.
Happily taking a nap.

Song 5

A dog says Bow-wow-wow.
And loves to dig bones.

CARE & MAINTENANCE

1. Keep the unit clean by wiping it with a slightly damp cloth.
2. Keep the unit out of direct sunlight and away from any direct heat source.
3. Remove the batteries if the unit will not be in use for an extended period of time.
4. Do not drop the unit on hard surfaces and do not expose the unit to excess moisture.

TROUBLESHOOTING

If for some reason the program/activity stops working or malfunctions, please follow these steps:

1. Please turn the unit **Off**.
2. Interrupt the power supply by removing the batteries.
3. Let the unit stand for a few minutes, then replace the batteries.
4. Turn the unit **On**. The unit should now be ready to play with again.
5. If the product still does not work, install a brand new set of batteries.

If the problem persists, please contact our Consumer Services Department and a service representative will be happy to help.

CONSUMER SERVICES

Creating and developing **VTech**[®] products is accompanied by a responsibility that we at **VTech**[®] take very seriously. We make every effort to ensure the accuracy of the information, which forms the value of our products. However, errors sometimes can occur. It is important for you to know that we stand behind our products and encourage you to call our Consumer Services Department with any problems and/or suggestions that you might have. A service representative will be happy to help you.

UK Customers:

Phone: 0330 678 0149 (from UK) or +44 330 678 0149 (outside UK)

Website: www.vtech.co.uk/support

Australian Customers:

Phone: 1800 862 155

Website: support.vtech.com.au

NZ Customers:

Phone: 0800 400 785

Website: support.vtech.com.au

PRODUCT WARRANTY/ CONSUMER GUARANTEES

UK Customers:

Read our complete warranty policy online at vtech.co.uk/warranty.

Australian Customers:

VTECH ELECTRONICS (AUSTRALIA) PTY LIMITED –
CONSUMER GUARANTEES

Under the Australian Consumer Law, a number of consumer guarantees apply to goods and services supplied by VTech Electronics (Australia) Pty Limited. Please refer to vtech.com.au/consumerguarantees for further information

**Visit our website for more
information about our products,
downloads, resources and more.**

www.vtech.co.uk
www.vtech.com.au

